



Sliding Door System Terra H

ST.1061.TEH



Sliding Door System

TERRA H ST.1061.TEH

The wheel of the Terra H door system is concealed in a stainless steel case which is recessed into the wooden door. This door system is especially suitable for rooms with no load-bearing ceiling.

Door weight max. 135 kg

Standard finish is decorative satin stainless steel. Partly polished, completely polished or PVD coated finishing (copper, gold or black) is available on request. Feel free to contact us, if you want to learn more about the Terra H system.



Wooden milling groove for Terra H:

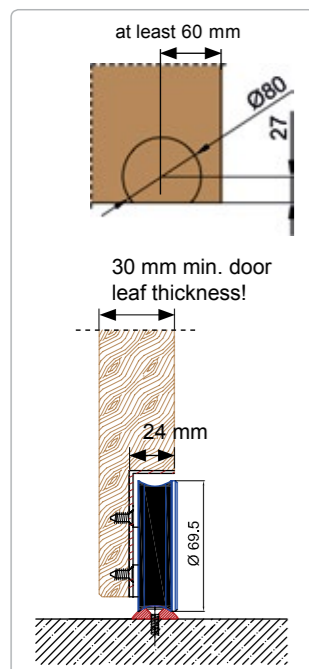

Floor rail measurements: Optional: recessed floor rail

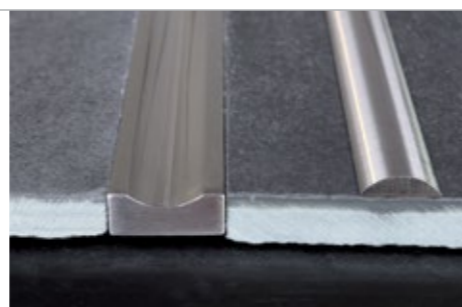
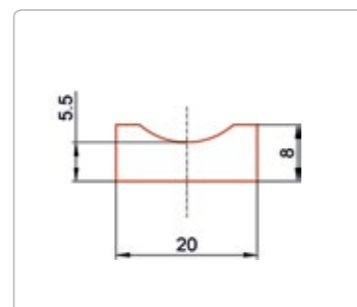
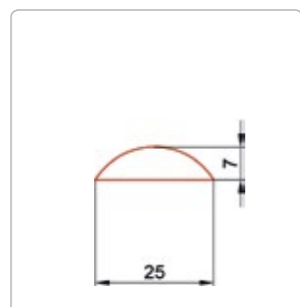

For Terra systems with the rails flush-mounted to the floor, the floor rollers are supplied suitably tailored!





Sliding Door System TERRA H ST.1061.TEH



MWE guide profiles are always made of stainless steel!

- The profiles can be adjusted to glass thicknesses on an individual basis
- Profile ends can be closed with a welded lid of stainless steel, thus providing a clean end
- The surface finish is provided to a quality of grain 600 (jewellery quality) (mirror finish possible)

If installation is onto a wall or glass, the holes on the guide profile are covered with clip lids.

ST.4040.TE Wall / ceiling guide profile, one-part

The guide profile is divided from a length of 3 metres!

Wall fastener for one-part guide profile

Delivery includes clip lid

ST.2100.TE

Glass fastener for one-part guide profile

Incl. distance spacer sleeve, wall distance in accordance with customer information

ST.2176.TE.S

Stopper for one-part guide profile

ST.3060.TE

Wall angle for one-part guide profile

ST.2100.TE.W

Lid for one-part guide profile

For a closed front side (welded)

ST.4060.TE

Mirror-finished surfaces

Mirror finished as part of manufacture

Price: 45 % surcharge per component / system

Variant 1: Standard ceiling fastener

One-part guide profile

Variant 2: Standard wall fastener

Fastening with angle (in the scope of supply): no visible screws from the front!

One-part guide profile

Variant 3: ST.2100.TE wall fastener

Bohrung wird durch Kappe verdeckt.

ST.2100.TE wall fastener with spacer sleeves

Different wall spacer sleeves to compensate for e.g. skirting boards or frames in 5 mm steps available. Give base measurement / wall distance when ordering!

One-part guide profile

Variant 4: ST.2176.TE.S glass fastener

Bohrung wird durch Kappe verdeckt.

Glass fastening with spacer sleeves

Different glass spacer sleeves to compensate for e.g. skirting boards or frames in 5 mm steps available. Give base measurement / wall distance when ordering!

One-part guide profile

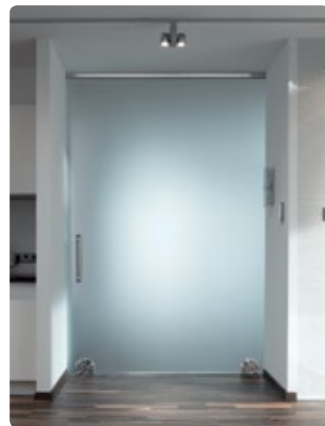

MWE guide profiles are always made of stainless steel!

- The profiles can be adjusted to glass thicknesses on an individual basis
- Profile ends are closed with a welded lid as standard, thus providing a clean end
- The surface finish is provided to a quality of grain 600 (jewellery quality) (mirror finish possible)

ST.4053 Wall / ceiling guide profile, two-parts, for MWE soft stop technology

The guide profile is divided from a length of 3 metres!

MWE soft stop technology for Terra systems

ST.3660

Incl. fasteners, dampers, catches and grid plates

Caution: Max. door leaf weight 75 kg

MWE standard:
The delivery of the two-part guide profiles takes place with the lids welded for closed front sides.

Caution:
Please indicate if closed front sides are not necessary (e.g. niche area)

Glass fastener for two-parts guide profile

Incl. distance spacer sleeve, glass distance in accordance with customer information

ST.2176.TE.S

Wall fastener for two-parts guide profile

Incl. rosette, spacer sleeve, screw and wall plug, wall distance in accordance with customer information

ST.2100.TE.S

Mirror-finished surfaces

Mirror finished as part of manufacture

Price: 45 % surcharge per component / system

Variant 1: Standard ceiling fastener

Two-parts guide profile

Advantage of a two-piece guide profile: no visible screws from the front!

Variant 2: Standard wall fastener

Two-parts guide profile

Advantage of a two-piece guide profile: no visible screws from the front!

Variant 3: ST.2100.TE.S wall fastener

Two-parts guide profile

ST.2100.TE.S wall fastener with spacer sleeves

Different wall spacer sleeves to compensate for e.g. skirting boards or frames in 5 mm steps available. Give base measurement / wall distance when ordering!

Variant 4: ST.2176.TE.S glass fastener

Two-parts guide profile

Glass fastening with spacer sleeves

Different glass spacer sleeves to compensate for e.g. skirting boards or frames in 5 mm steps available. Give base measurement / wall distance when ordering!

If the wall distance cannot be compensated for, it can be installed onto glass without a distance spacer. Advantage: small gap dimensions!



MANUFACTORY



MWE stands for high quality and great attention to detail. Our philosophy and mission is to provide products that keep up with the spirit of the time.

We keep meeting the highest requirements in terms of design, quality and functionality. Top MWE technology combined with excellent customer relationship management results in "Quality built on passion"!

Click here to browse through our catalogues and magazines:



Doors



Ladders



Showers



Door pulls

